



# GRAMMAR PARK GARDENS

The *best* of family living...

# STAGE 2 NOW SELLING

## Shepparton's premier new estate!

Stage 2 accommodates 22 lots ranging in size from 1101m<sup>2</sup> to 3221m<sup>2</sup>, 9 of which directly overlook the centrally located parks and gardens precinct.

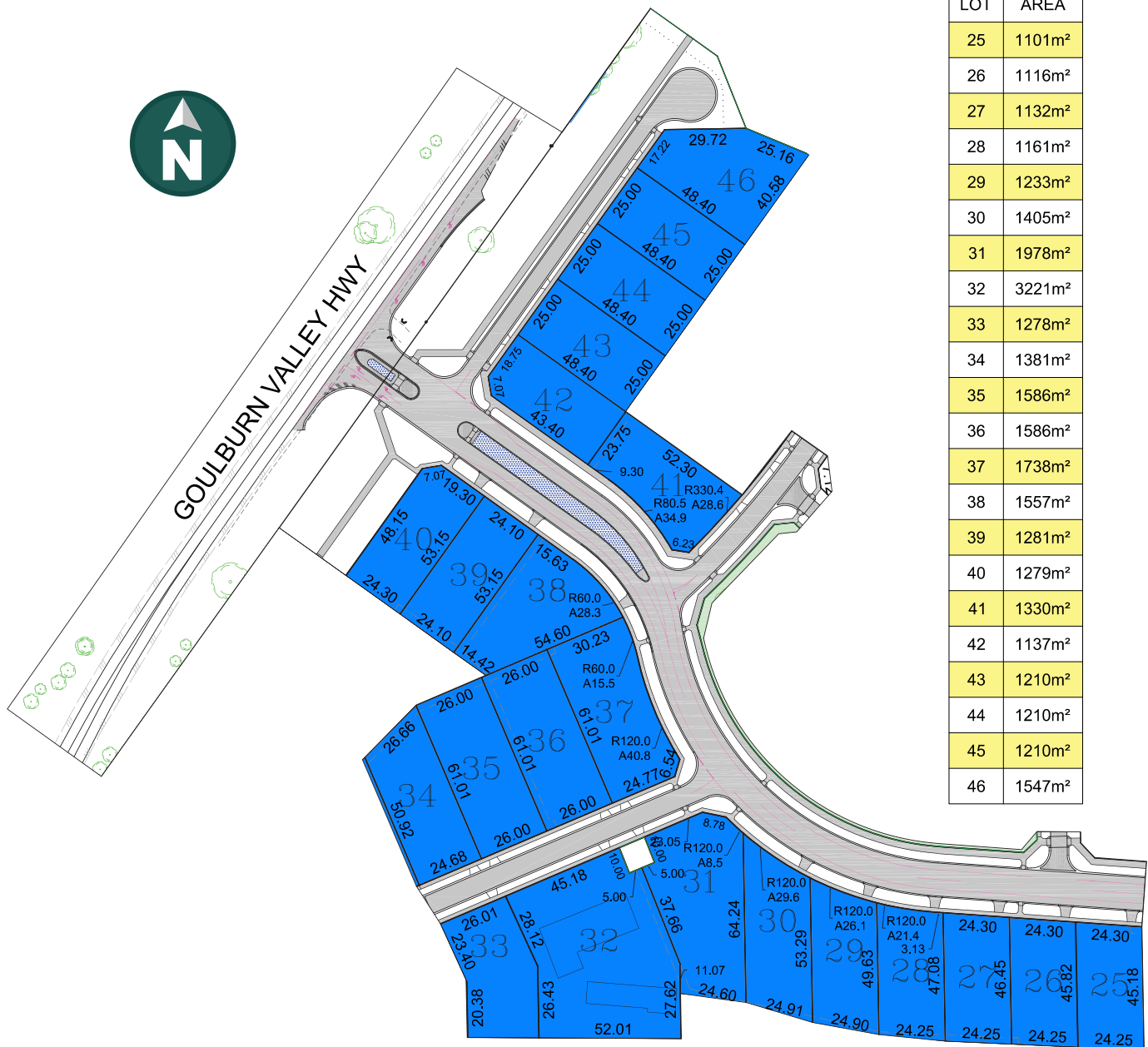

For further information visit:

[grammarparkgardens.com.au](http://grammarparkgardens.com.au)

Selling agents:

**YOUNGS & CO**  
REAL ESTATE

123 Wyndham St, Shepparton  
Ph. 03 5820 8777  
Glenn Young. 0438 579 993



**KEVIN HICKS**  
REAL ESTATE

228-232 Wyndham St, Shepparton  
Ph. 03 5821 8388  
Terry Shiels. 0448 573 820  
Kevin Hicks. 0428 271 270